

Changing light bulb for Terho Small

1

Separate the top from the glass.

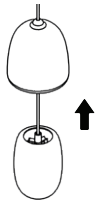

2

Grab the handle of the bulb and pull outwards. Do not be afraid to apply necessary force.

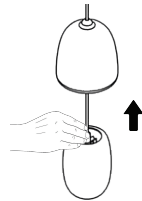

3

Unwind the bulb to replace it with a new one.

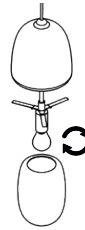

4

To place the bulb back in the glass, converge the arms of the clamp by pushing them downwards.



5

Insert the clamp into the glass. You can release your grip when the clamp is almost halfway inside the glass.

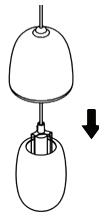

6

Push the clamp into the glass until it is fully inside. Then, connect the top with the glass.



7

Push the glass upwards or sideways with the palm of your hand to orientate it into a straight position.

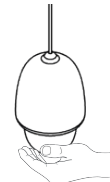

Changing light bulb for Terho Medium / Large

1

Lift the top from the glass.

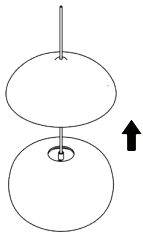

2

Grab the disc of the socket and move to one side of the glass.

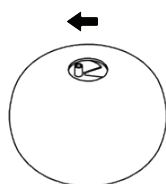

3

Tilt the disc and glide glass into the gap.

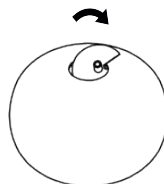

4

Twist the disc outwards.

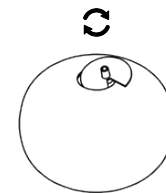

5

Once the disc is out, unwind the bulb to replace it with a new one.

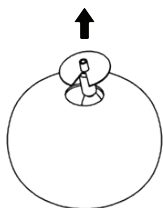

6

To place the socket back in the glass, proceed in the reverse order and glide the wooden top in place.

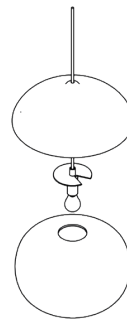

7

Push the glass upwards or sideways with the palm of your hand to orientate it into a straight position.

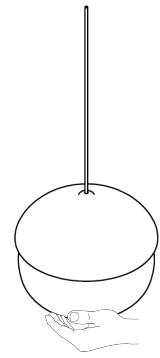

EU: E14 (small) - E27 (Medium & Large). UL: E12 (Small) - E26 (Medium & Large) **Bulb not included.**

Do not use regular bulbs as the wooden part will cause overheating. Max 6W LED. 220-240V. ac 50Hz.

For installation please consult your local electrician.

WHY LED?

LED lighting reduce environmental impact, resulting in power management solutions that are safe, reliable and efficient. Upgrading lighting to LED not only saves you up to 85 % in energy costs, but also reduces waste going to landfill and greenhouse gas emissions.

mater

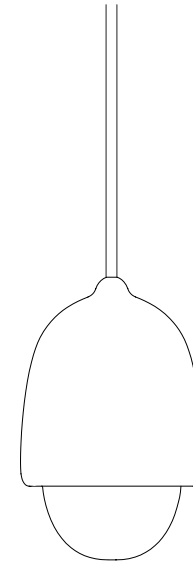

Considering the planet,
its resources and its people.

@materdesign

www.materdesign.com

Terho Pendant, Small

Designed by Maija Puoskari

Thank you for purchasing the Terho Pendant

Terho Pendant, Small

Linden wood & mouth blown glass



Designed by
Maija Puoskari

Dimensions
Ø 13,5 cm H 21,5 cm / Ø 5.3" H 8.5"

Weight
1 kg / 2.2 lbs

Cord length
2 m / 78"

Canopy
Included

Materials
Solid linden wood. Mouth blown glass.

Colours
Black lacquered wood / Smoked glass
Natural lacquered wood / White Opal glass

Light Source
E27, max 6W LED. Bulb not included

Certifications



Maintenance guide

For daily care it is recommended to dust the pendant with a soft, dry cloth. Lacquered and stained wood can be cleaned with a soft cloth wrung in a mild solution of lukewarm water and a universal cleaning detergent. Always follow the wood grains and always dry with a soft dry cloth immediately afterwards.

Avoid use of abrasive and aggressive cleaning detergents as this will damage the surface of the lacquered or stained wood. Avoid placing wooden furniture in direct sunlight, excessive heat or humidity.

Clean the glass using a dry soft cloth. If the glass needs a more thorough cleaning, it is recommended to use a soft cloth in combination with a standard glass cleaning detergent and dry off with a soft dry cloth afterwards. Avoid using abrasive cleaning agents on glass as this will damage the surface.

Installation Guide

Components

1x Pendant

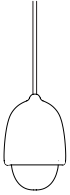

1 x Canopy



1 x Metal bracket



1 x Wire fixture



1 x Plastic screw



1 x Nut



2 x Screws



Safety precautions

Consult a professionally qualified electrician if in any doubt. Before starting the installation, disconnect the power supply by turning off the circuit breaker or by removing the fuse at the power off. Using the light switch is not sufficient to prevent electrical shock.

1

Ensure power supply is turned off. Mount the metal bracket securely in the ceiling with screws and wall plugs appropriate for the ceiling. Note that screws and plugs for the ceiling are not included.

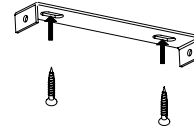

2

Assemble the canopy using the nut and wire fixture.

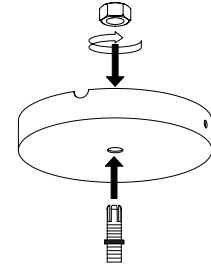

3

To determine the right height for the lamp, pass the electrical cord through the plastic screw and then through the wire fixture. Tighten the plastic screw around the wire fixture when you have the desired length.

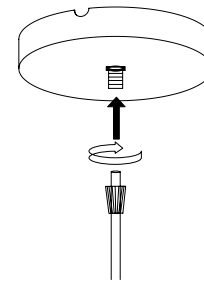

4

Assemble the canopy to the metal bracket mounted in the ceiling using the two small screws.

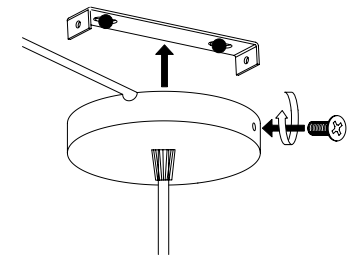

5

Ensure the power supply is turned off. Remove any frame or cover from the electric outlet where you want to install the lamp. Mount the cover or frame to the cord before installing the lamp.

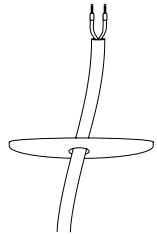

6

Connect the brown wire (L) to M1 in the electric outlet and the blue wire (N) to N in the electric outlet.

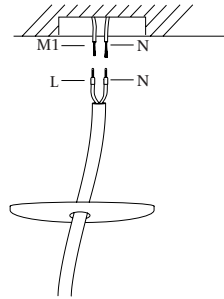

9

To assemble the lamp, push the arms of the clamp downwards and carefully assemble the lamp with the glass.

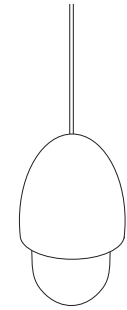
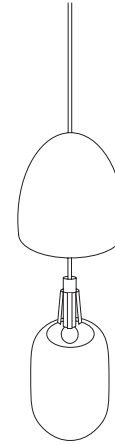

10

Now you can enjoy your Terho Lamp.

7

Separate the top part of the lamp from the glass part. Grab the handle of the light source and pull it out. It may be a bit tight.

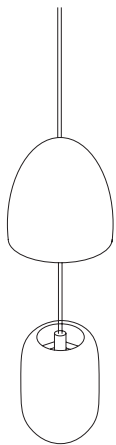

8

Install the recommended light source.

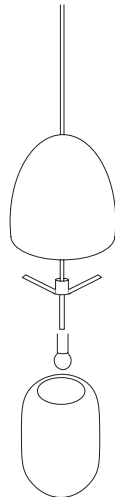

mater

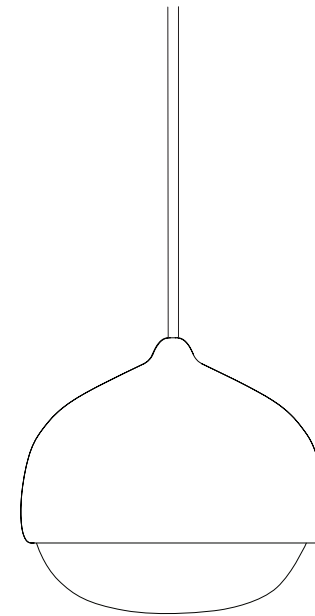

Considering the planet,
its resources and its people.

@materdesign

www.materdesign.com

Terho Pendant, Medium

Designed by Maija Puoskari

Thank you for purchasing the Terho Pendant

Terho Pendant, Medium

Linden wood & mouth blown glass



Designed by
Maija Puoskari

Dimensions
Ø 24 cm H 21,5 cm / Ø 9.4" H 8.5"

Weight
2 kg / 4.4 lbs

Cord length
2 m / 78"

Canopy
Included

Materials
Solid linden wood. Mouth blown glass.

Colours
Black lacquered wood / Smoked glass
Natural lacquered wood / White Opal glass

Light Source
E27, max 6W LED. Bulb not included

Certifications



Maintenance guide

For daily care it is recommended to dust the pendant with a soft, dry cloth. Lacquered and stained wood can be cleaned with a soft cloth wrung in a mild solution of lukewarm water and a universal cleaning detergent. Always follow the wood grains and always dry with a soft dry cloth immediately afterwards.

Avoid use of abrasive and aggressive cleaning detergents as this will damage the surface of the lacquered or stained wood. Avoid placing wooden furniture in direct sunlight, excessive heat or humidity.

Clean the glass using a dry soft cloth. If the glass needs a more thorough cleaning, it is recommended to use a soft cloth in combination with a standard glass cleaning detergent and dry off with a soft dry cloth afterwards. Avoid using abrasive cleaning agents on glass as this will damage the surface.

Installation Guide

Components

1x Pendant

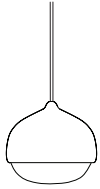

1 x Canopy



1 x Metal bracket

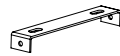

1 x Wire fixture



1 x Plastic screw



1 x Nut



2 x Screws



Safety precautions

Consult a professionally qualified electrician if in any doubt. Before starting the installation, disconnect the power supply by turning off the circuit breaker or by removing the fuse at the power off. Using the light switch is not sufficient to prevent electrical shock.

1

Ensure power supply is turned off. Mount the metal bracket securely in the ceiling with screws and wall plugs appropriate for the ceiling. Note that screws and plugs for the ceiling are not included.

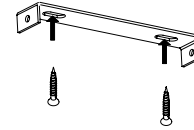

2

Assemble the canopy using the nut and wire fixture.

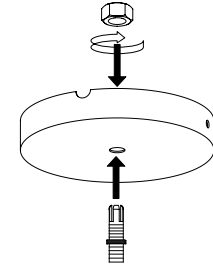

3

To determine the right height for the lamp, pass the electrical cord through the plastic screw and then through the wire fixture. Tighten the plastic screw around the wire fixture when you have the desired length.

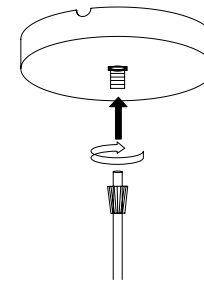

4

Assemble the canopy to the metal bracket mounted in the ceiling using the two small screws.

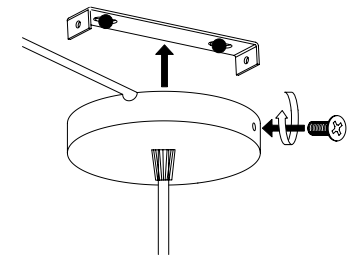

5

Ensure the power supply is turned off. Remove any frame or cover from the electric outlet where you want to install the lamp. Mount the cover or frame to the cord before installing the lamp.

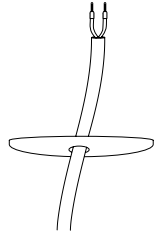

6

Connect the brown wire (L) to M1 in the electric outlet and the blue wire (N) to N in the electric outlet.

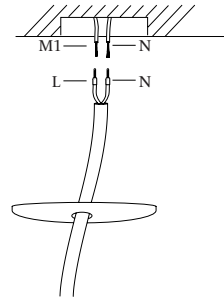

9

Twist the disc outwards to remove it from the glass.

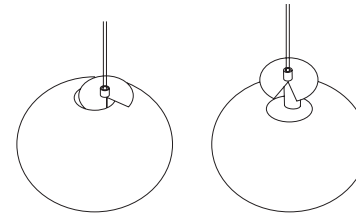

10

Install the recommended light source and repeat the previous steps in reverse order.

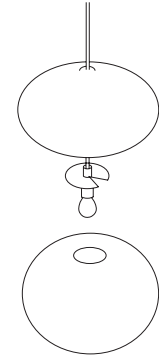

7

To install the light source separate the top of the lamp from the glass.

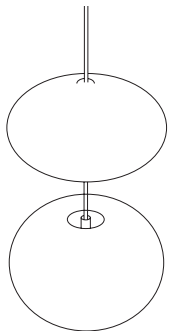

8

While holding onto the glass shade, carefully move the handle on the disc to the side and rotate the disc so that a gap appears between the edge of the glass shade.

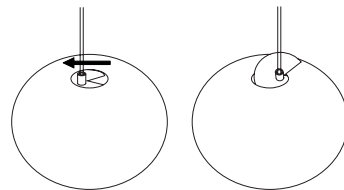

11

Now you can enjoy your Terho pendant.

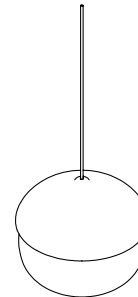

mater

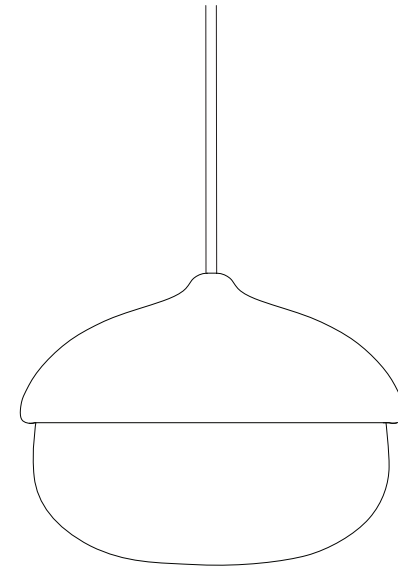

Considering the planet,
its resources and its people.

@materdesign

www.materdesign.com

Terho Pendant, Large

Designed by Maija Puoskari

Thank you for purchasing the Terho Pendant

Terho Pendant, Large

Linden wood & mouth blown glass



Designed by
Maija Puoskari

Dimensions
Ø 31,5 cm H 30 cm / Ø 12.4" H 11.8"

Weight
4 kg / 8.8 lbs

Cord length
2 m / 78"

Canopy
Included

Materials
Solid linden wood. Mouth blown glass.

Colours
Black lacquered wood / Smoked glass
Natural lacquered wood / White Opal
glass

Light Source
E27, max 6W LED. Bulb not
included

Certifications
CE  

Maintenance guide

For daily care it is recommended to dust the pendant with a soft, dry cloth. Lacquered and stained wood can be cleaned with a soft cloth wrung in a mild solution of lukewarm water and a universal cleaning detergent. Always follow the wood grains and always dry with a soft dry cloth immediately afterwards.

Avoid use of abrasive and aggressive cleaning detergents as this will damage the surface of the lacquered or stained wood. Avoid placing wooden furniture in direct sunlight, excessive heat or humidity.

Clean the glass using a dry soft cloth. If the glass needs a more thorough cleaning is necessary, it is recommended to use a soft cloth in combination with a standard glass cleaning detergent and dry off with a soft dry cloth afterwards. Avoid using abrasive cleaning agents on glass as this will damage the surface.

Installation Guide

Components

1x Pendant

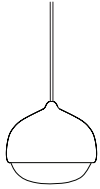

1 x Canopy



1 x Metal bracket



1 x Wire fixture



1 x Plastic screw



1 x Nut



2 x Screws



Safety precautions

Consult a professionally qualified electrician if in any doubt. Before starting the installation, disconnect the power supply by turning off the circuit breaker or by removing the fuse at the power off. Using the light switch is not sufficient to prevent electrical shock.

1

Ensure power supply is turned off. Mount the metal bracket securely in the ceiling with screws and wall plugs appropriate for the ceiling. Note that screws and plugs for the ceiling are not included.

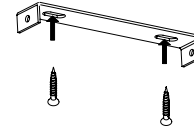

2

Assemble the canopy using the nut and wire fixture.

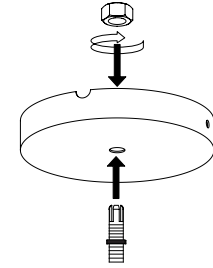

3

To determine the right height for the lamp, pass the electrical cord through the plastic screw and then through the wire fixture. Tighten the plastic screw around the wire fixture when you have the desired length.

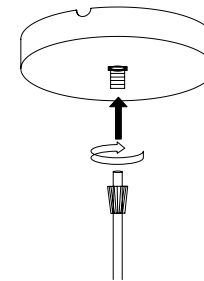

4

Assemble the canopy to the metal bracket mounted in the ceiling using the two small screws.

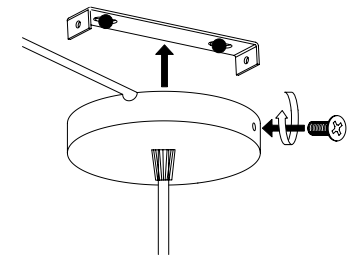

5

Ensure the power supply is turned off. Remove any frame or cover from the electric outlet where you want to install the lamp. Mount the cover or frame to the cord before installing the lamp.

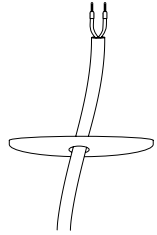

6

Connect the brown wire (L) to M1 in the electric outlet and the blue wire (N) to N in the electric outlet.

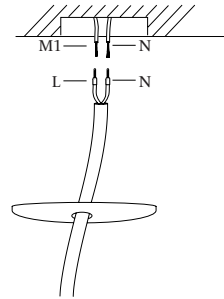

9

Twist the disc outwards to remove it from the glass.

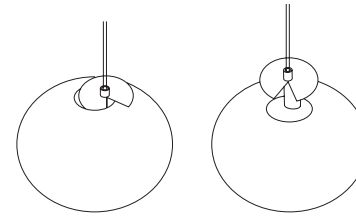

10

Install the recommended light source and repeat the previous steps in reverse order.

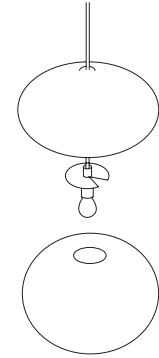

7

To install the light source separate the top of the lamp from the glass.

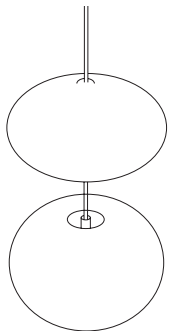

8

While holding onto the glass shade, carefully move the handle on the disc to the side and rotate the disc so that a gap appears between the edge of the glass shade.

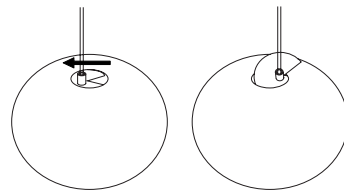

11

Now you can enjoy your Terho pendant.

