

# Canopy

by Mater

mater

For this product you will need two screws and two plugs in addition to the components that are included.

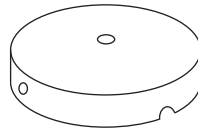
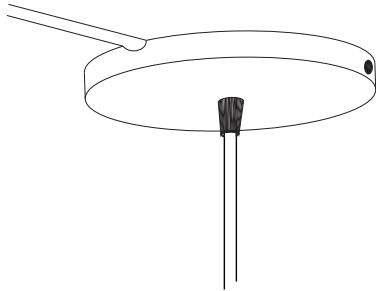

1 x ceiling cap



1 x cord grip sleeve



2 x screws

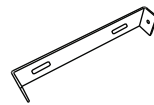

1 x ceiling bracket



1 x cord grip



1 x bolt

1

Drill holes and insert wall plugs and screw the bracket into the ceiling.

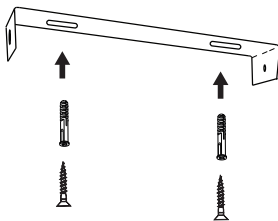

2

Pull the cord grip sleeve on to the cord as shown.

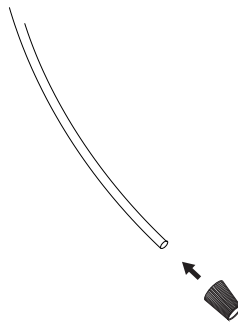

3

Fix the cord grip and bolt on to the ceiling cap.

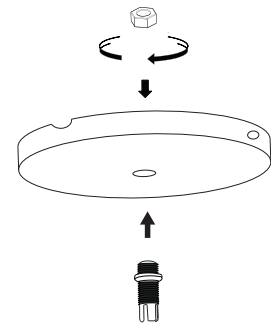

4

Pull the pendant's cord at the desired length, fix the cord grip sleeve in place and tighten.

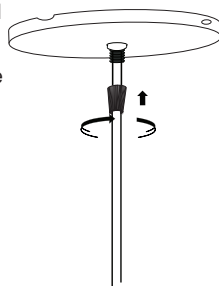

5

Use the supplied screws to seal the ceiling cap to the bracket mounted in the ceiling.

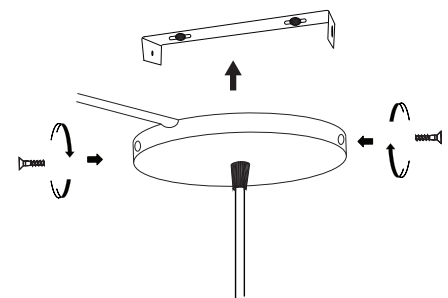

# Liuku

by Maija Puoskari

mater

## Changing light bulb\* of the wooden Liuku Drop

1

Separate the glass from wooden base.

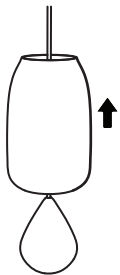

2

Pull the bulb with the cord out of the wooden base.



3

Unwind the bulb to replace it with a new one.



4

Push the bulb with the cord back into the wooden base.



5

Slide the glass back to place nestling on the wooden base.

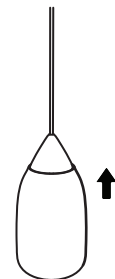

## Changing light bulb\* of the wooden Liuku Ball

1

Separate the glass from wooden base.

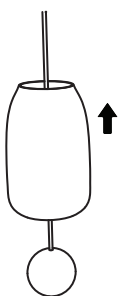

2

Pull the bulb with the cord out of the wooden base.



3

Unwind the bulb to replace it with a new one.



4

Push the bulb with the cord back into the wooden base.



5

Slide the glass back to place nestling on the wooden base.

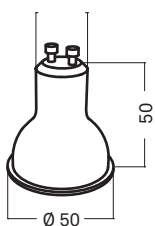
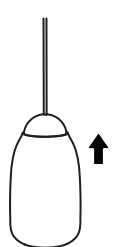

\*LED Bulb included (GU10). For installation please consult your local electrician.

Use only GU10. Max 9W LED, 220-240V. ac 50Hz.

Do not use regular bulbs.

### WHY LED?

LED lighting reduce environmental impact, resulting in power management solutions that are safe, reliable and efficient. Upgrading lighting to LED not only saves you up to 85 % in energy costs, but also reduces waste going to landfill and greenhouse gas emissions.